

Chestnut Avenue New 1.5FE Primary School Project Appraisal

Key

- HCC Ownership Boundary
- Project Development Area
- ▶ Existing Pedestrian Access
- ▶ Existing Vehicular Access
- (A)** Proposed school building
- (B)** Avenue Park
- (C)** New housing
- (D)** Additional land for expansion to 2FE
- (E)** Proposed Local Centre and car parking

Proposed School:

- (1)** 2-storey 1.5fe primary school
- (2)** Main entrance
- (3)** Hall
- (4)** Classrooms
- (5)** Kitchen
- (6)** Early years play area
- (7)** Staff car park - 28 bays
- (8)** Waste storage
- (9)** Main playground
- (10)** Playing field/ pitches
- (11)** Key Stage One playground

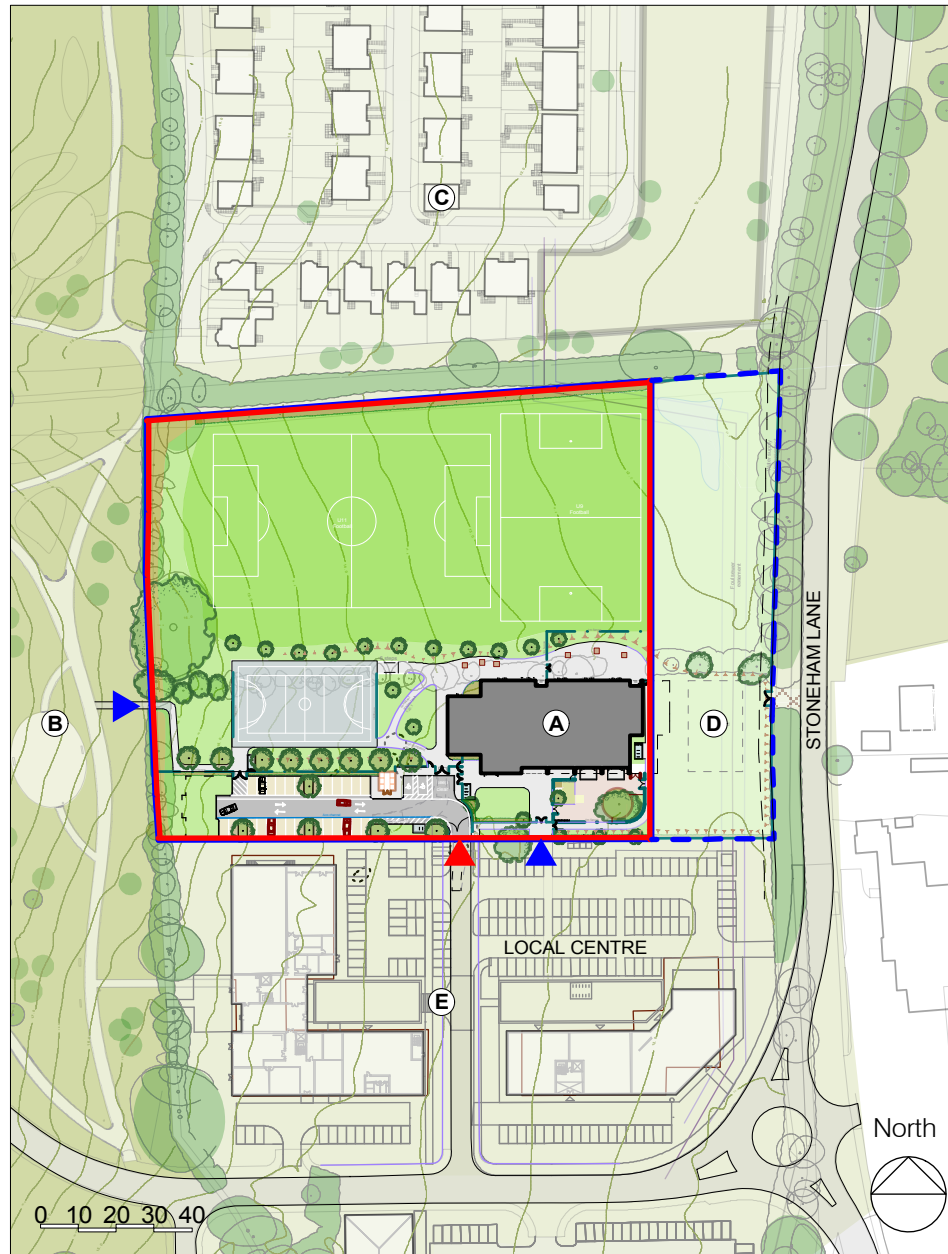

Site Plan



Proposed Site Plan



Perspective view of school frontage



Proposed South Elevation